

# CONTROL VALVE BODY DISASSEMBLY/ASSEMBLY

---

B3E051721100A10

## Control Valve Body Disassembly

### Caution

- Denting or scratching these components will reduce the ability of the transaxle to shift properly. When handling these components or the valve body that contains them, be careful not to drop or hit them.

1. Disassemble in the order indicated in the table.
2. Neatly arrange the removed parts to avoid confusing the similar parts.

### Warning

- Using compressed air can cause dirt and other particles to fly out, causing injury to the eyes. Wear protective eye wear whenever using compressed air.
3. Clean the removed parts with cleaning solvent, then use compressed air to dry them. Use compressed air to clean out all holes and passages.

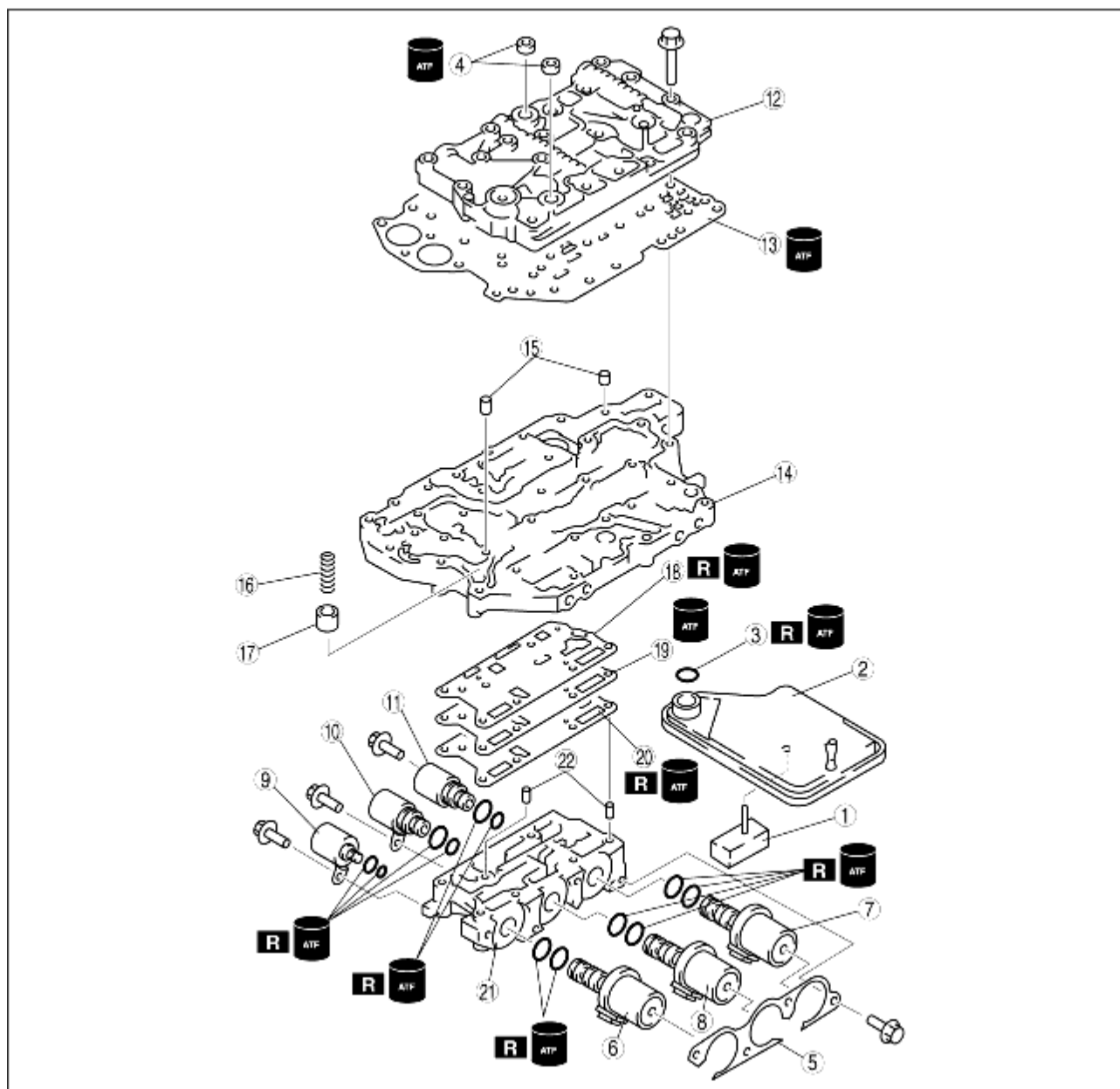

B3E0517A148

1	Transaxle fluid temperature sensor
2	Oil strainer
3	O-ring
4	Packing
5	Bracket
6	Shift solenoid A
7	Shift solenoid B
8	Shift solenoid C
9	Pressure control solenoid
10	Shift solenoid D
11	Shift solenoid E
12	Upper control valve body
13	Seal plate
14	Main control valve body
15	Tubular pin

16	Pressure modifier accumulator spring
17	Pressure modifier accumulator
18	Gasket D
19	Separator plate
20	Gasket C
21	Solenoid control valve body
22	Tubular pin

## Disassembly procedure

1. Remove the oil strainer.
2. Remove the O-ring from the oil strainer.
3. Remove the packing.
4. Remove the bracket.

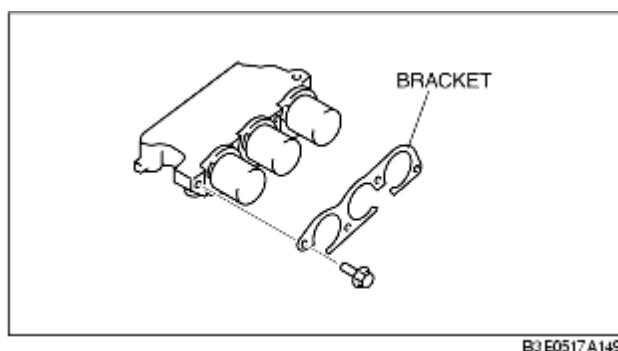

5. Remove the shift solenoid A, B, C.

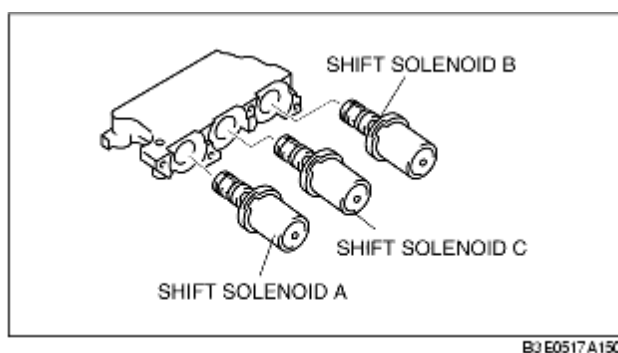

6. Remove the pressure control solenoid, shift solenoid D, E.

7. Loosen the bolts evenly in the pattern shown.

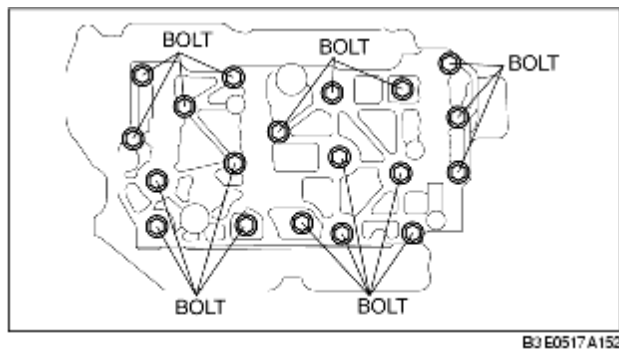

8. Remove the upper control valve body.

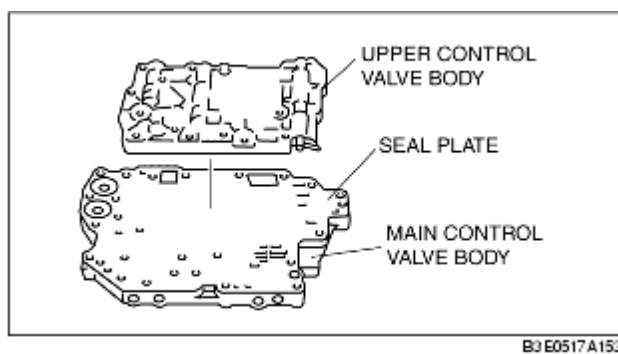

9. Remove the seal plate.

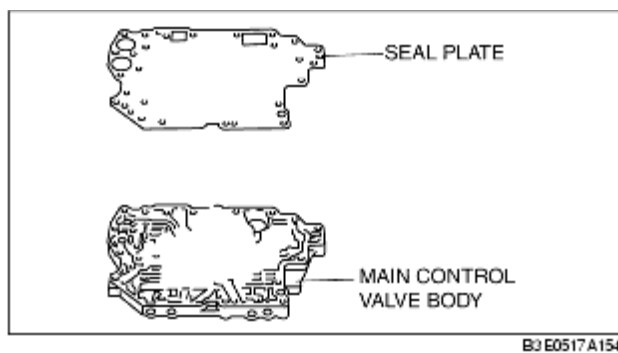

10. Remove the main control valve body.

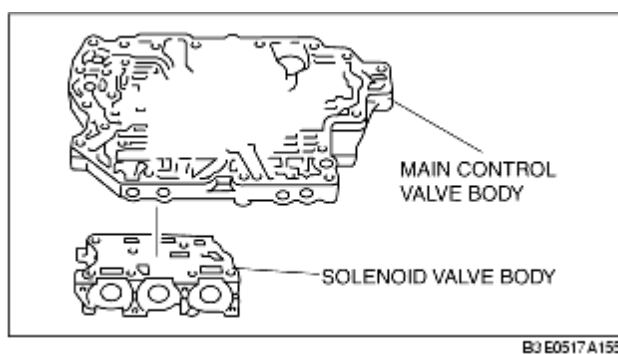

11. Remove the tubular pins, pressure modifier accumulator spring and pressure modifier accumulator from

the main control valve body.

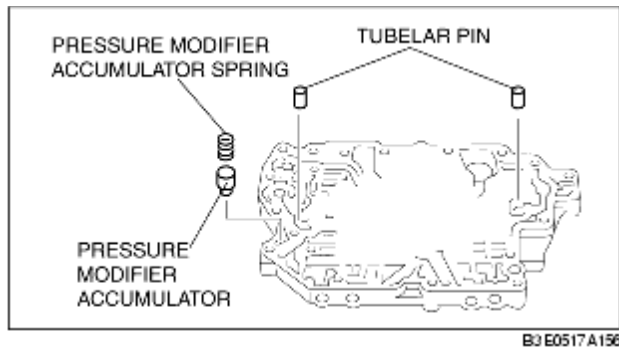

12. Remove the gasket D, separator plate and gasket C.

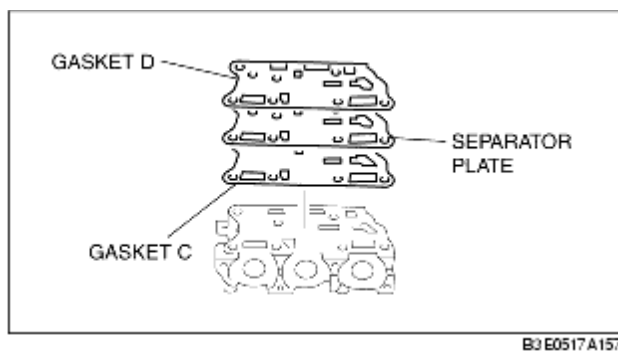

13. Remove the tubular pins.

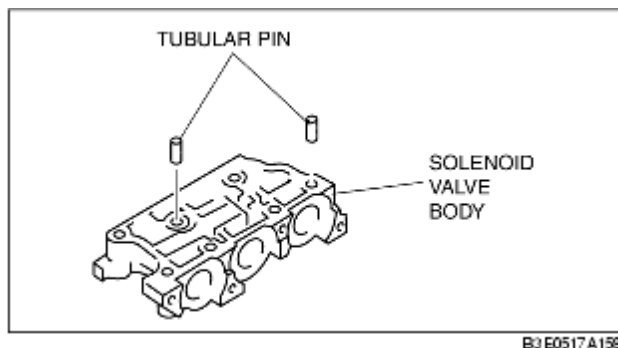

## Upper Control Valve Body Disassembly/Assembly

### Caution

- Denting or scratching these precisely machined components will reduce the ability of the transaxle to shift properly. When handling these components or the valve body that contains them, be careful not to drop or hit them.

### Note

- If a valve does not slide out under its own weight, place the valve body open-side down and tap on the valve body lightly with a plastic hammer.

1. Disassemble in the order indicated in the table.

### Warning

- Using compressed air can cause dirt and other particles to fly out, causing injury to the eyes. Wear protective eye wear whenever using compressed air.

- Clean all parts and holes using compressed air and apply ATF to them immediately before assembly.
- Assemble in the reverse order of disassembly.

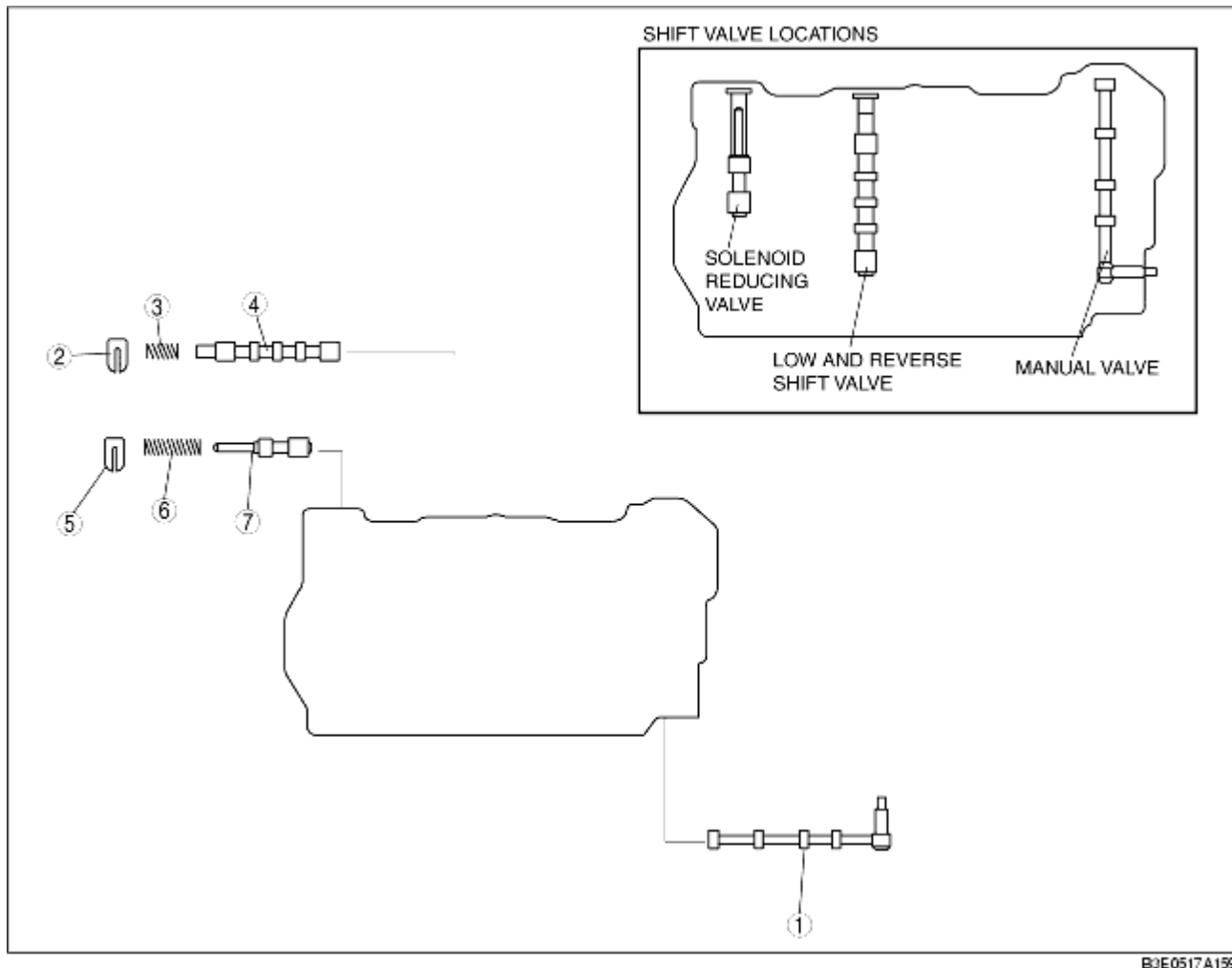

B3E0517A199

1	Manual valve
2	Retainer
3	Low and reverse shift valve spring
4	Low and reverse shift valve
5	Retainer
6	Solenoid reducing valve spring
7	Solenoid reducing valve

## Assembly procedure

- Measure the spring free length.

Item	Outer diameter mm {in}	Free length mm {in}	No. of coils	Wire diameter mm {in}
Low and reverse shift valve spring	8.7 {0.343}	31.3 {1.232}	9.0	0.8 {0.031}

Solenoid reducing valve spring	8.7 {0.343}	44.2 {1.740}	16.0	1.1 {0.043}
--------------------------------	-------------	--------------	------	-------------

- If not as specified, replace the springs.

2. Install the solenoid reducing valve, solenoid reducing valve spring and retainer.
3. Install the low and reverse shift valve, low and reverse shift valve spring and retainer.

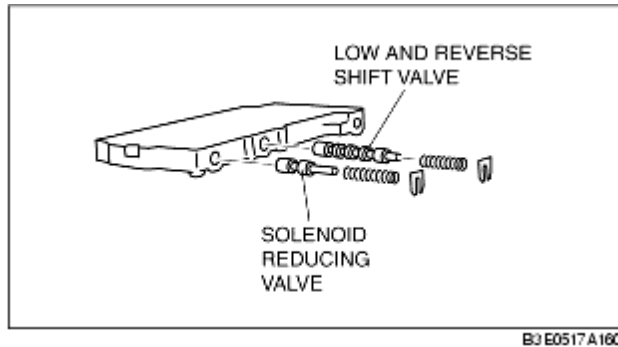

4. Install the manual valve.

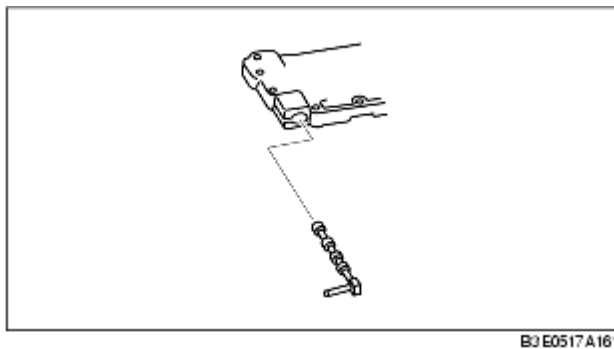

## Main Control Valve Body Disassembly/Assembly

### Caution

- Denting or scratching these precisely machined components will reduce the ability of the transaxle to shift properly. When handling these components or the valve body that contains them be careful not to drop or hit them.

### Note

- If a valve does not slide out under its own weight, place the valve body open-side down and tap on the valve body lightly with a plastic hammer.

1. Disassemble in the order indicated in the table.

### Warning

- Using compressed air can cause dirt and other particles to fly out, causing injury to the eyes. Wear protective eye wear whenever using compressed air.

2. Clean all parts and holes using compressed air and apply ATF to them immediately before assembly.
3. Assemble in the reverse order of disassembly.

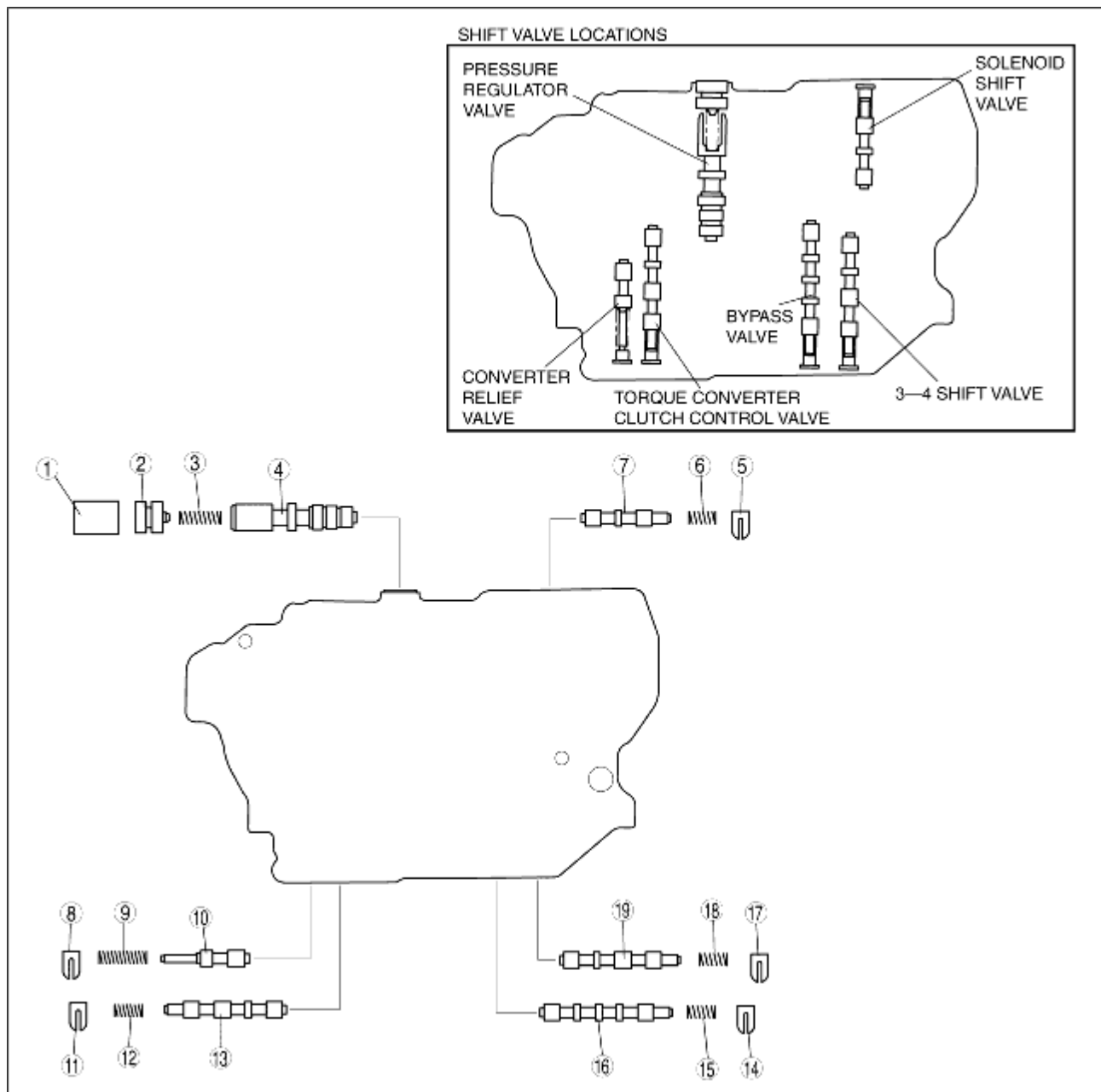

B3E0517A162

1	Retainer
2	Stopper plug
3	Pressure regulator valve spring
4	Pressure regulator valve
5	Retainer
6	Solenoid shift valve spring
7	Solenoid shift valve
8	Retainer
9	Converter relief valve spring
10	Converter relief valve
11	Retainer
12	Torque converter clutch valve spring
13	Torque converter clutch valve
14	Retainer



15	Bypass valve spring
16	Bypass valve
17	Retainer
18	3-4 shift valve spring
19	3-4 shift valve

## Assembly procedure

1. Measure the spring free length.

Item	Outer diameter mm {in}	Free length mm {in}	No. of coils	Wire diameter mm {in}
Pressure regulator valve spring	7.9 {0.311}	36.3 {1.429}	13.2	0.9 {0.035}
Solenoid shift valve spring	8.3 {0.327}	35.1 {1.382}	12.0	0.6 {0.024}
Converter relief valve spring	9.0 {0.354}	42.5 {1.673}	14.2	1.3 {0.051}
Torque converter clutch control valve spring	8.7 {0.343}	31.3 {1.232}	9.0	0.8 {0.031}
Bypass valve spring	8.7 {0.343}	31.3 {1.232}	9.0	0.8 {0.031}
3-4 shift valve spring	8.7 {0.343}	31.3 {1.232}	9.0	0.8 {0.031}

- If not as specified, replace the springs.

2. Install the 3-4 shift valve, 3-4 shift valve spring, and retainer.

3. Install the bypass valve, bypass valve spring, and retainer.

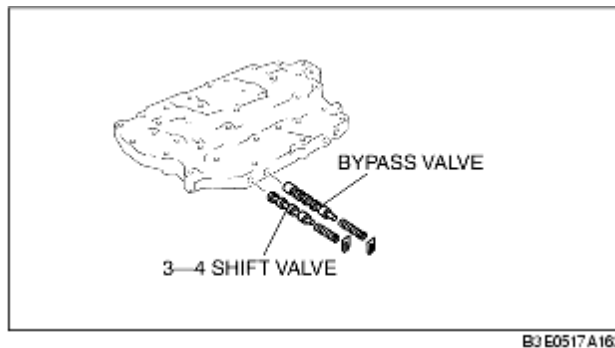

4. Install the torque converter clutch control valve, torque converter clutch control valve spring, and retainer.

5. Install the converter relief valve, converter relief valve spring, and retainer.

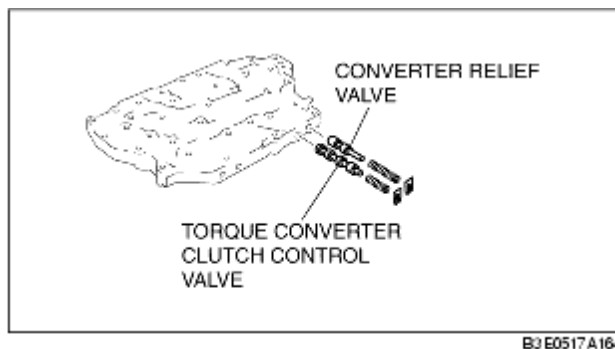

6. Install the solenoid shift valve, solenoid shift valve spring, and retainer.

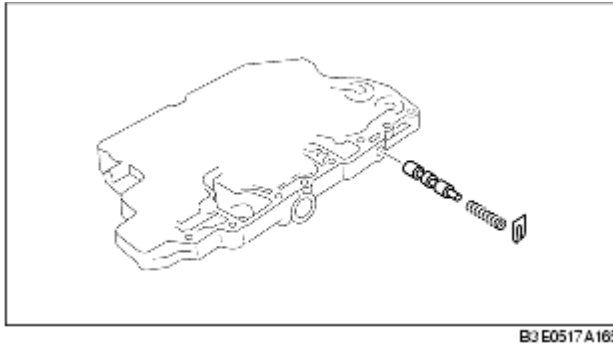

7. Install the pressure regulator valve, pressure regulator valve spring, and retainer.

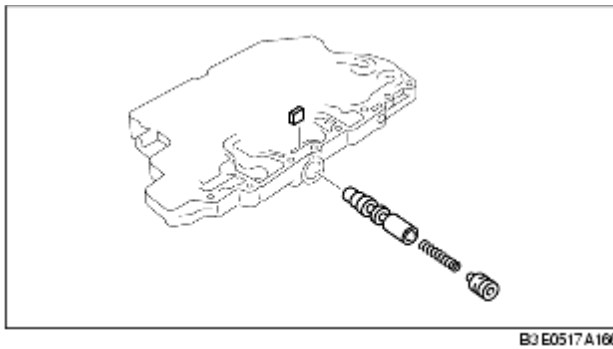

## Control Valve Body Assembly

1. Verify that all parts are clean and free of dust and other small particles.
2. Apply ATF to all parts.
3. Assemble in the reverse order of disassembly.

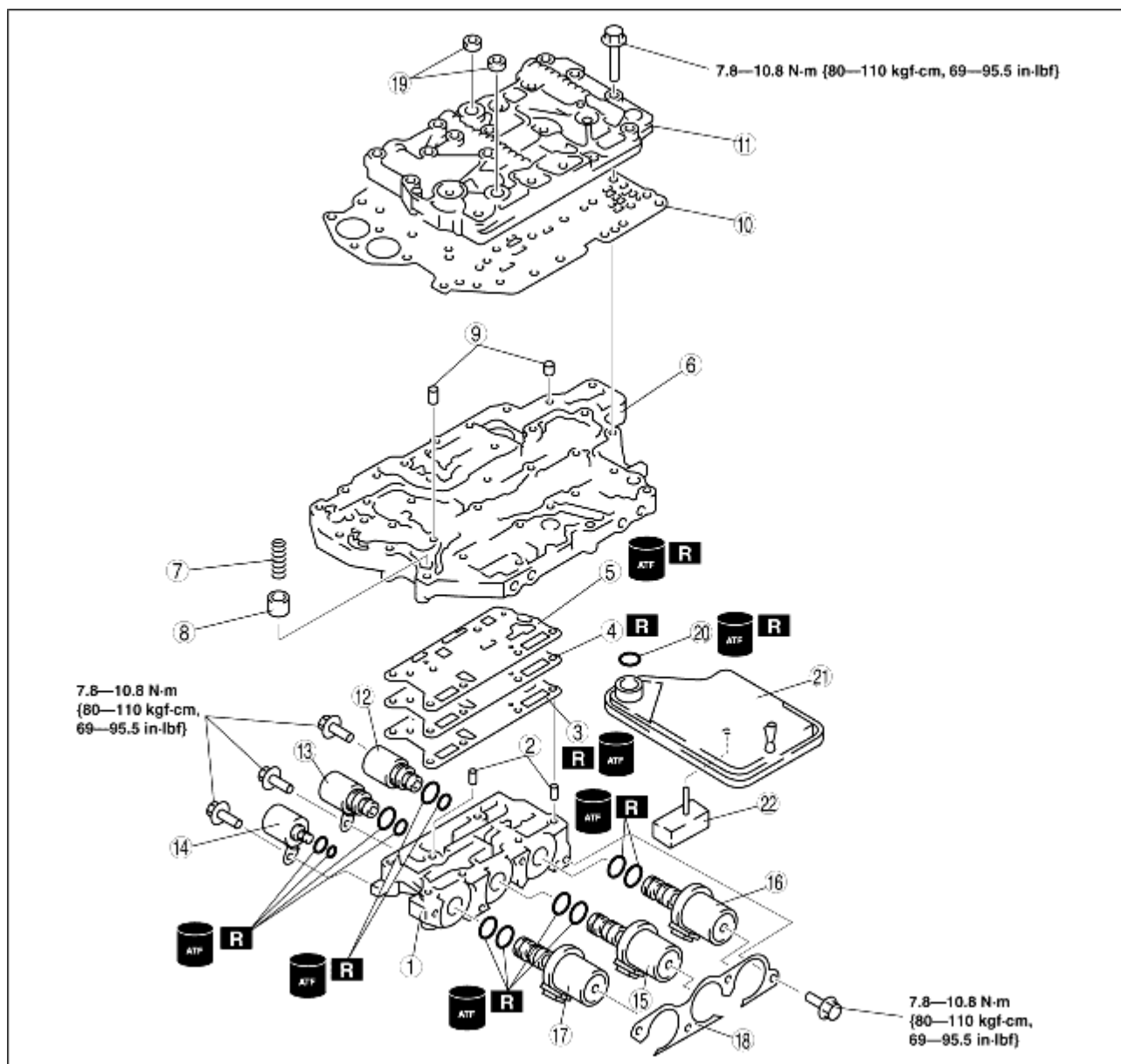

B3E0517A167

1	Solenoid control valve body
2	Tubular pin
3	Gasket C
4	Separator plate
5	Gasket D
6	Main control valve body
7	Pressure modifier accumulator
8	Pressure modifier accumulator spring
9	Tubular pin
10	Seal plate
11	Upper control valve body
12	Shift solenoid E
13	Shift solenoid D
14	Pressure control solenoid
15	Shift solenoid C

16	Shift solenoid B
17	Shift solenoid A
18	Bracket
19	Packing
20	O-ring
21	Oil strainer
22	Transaxle fluid temperature sensor

## Assembly procedure

1. Install the tubular pins into the solenoid control valve body.

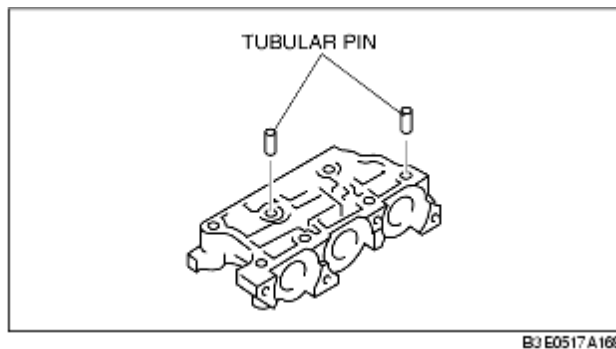

### Caution

- Do not confuse gaskets C and D.

2. Set the new gasket C, separator plate, and new gasket D on the solenoid control valve body.

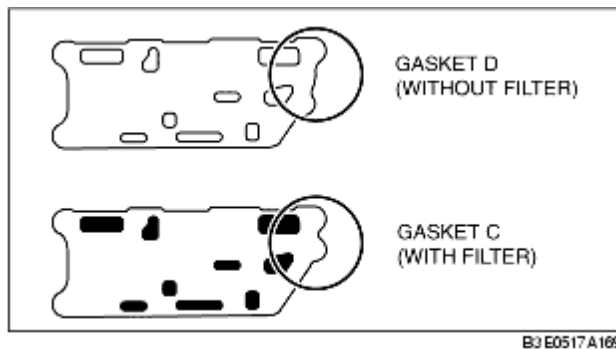

3. Install the pressure modifier accumulator and pressure modifier accumulator spring into the main control valve body.

### Pressure modifier accumulator spring free length

Outer diameter mm {in}	Free length mm {in}	No. of coils	Wire diameter mm {in}
11.0 {0.433}	23.0 {0.906}	6.6	1.5 {0.059}

4. Install the tubular pins into the main control valve body.

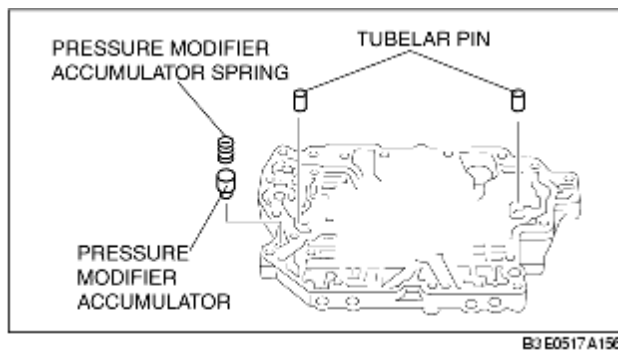

5. Set the main control valve body onto the solenoid control valve body.

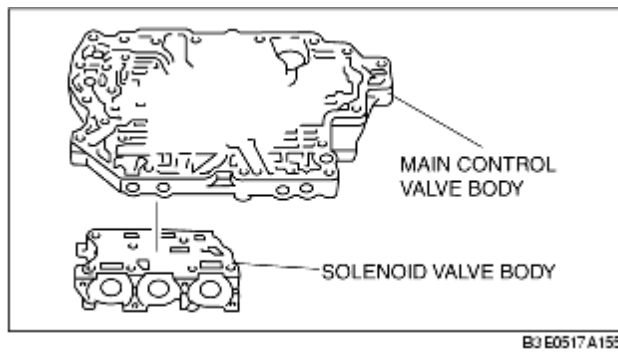

6. Set the seal plate on the main control valve body.

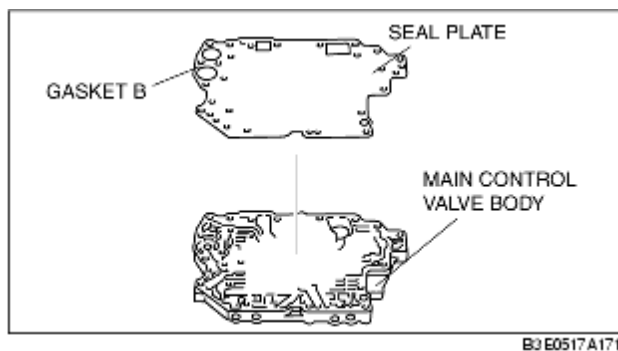

7. Set the upper control valve body onto the main control valve body.

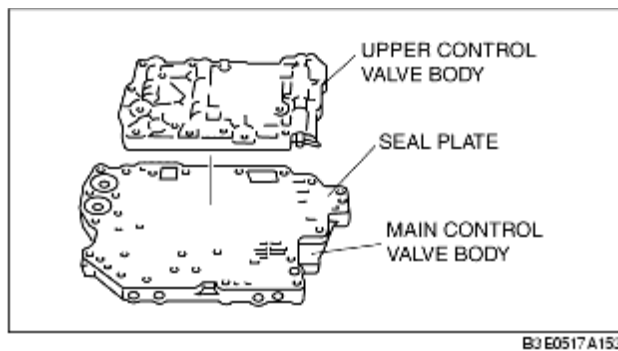

8. Hand-tighten the bolts shown in the figure. Each type of bolt has a different letter on its head. Match the bolt letter with the letter stamped next to its installation hole on the valve body.

**Bolts identification**

Identification mark	Length (measured from below the head) mm {in}
A	30 {1.181}
B	40 {1.575}
No mark	60 {2.362}

9. Tighten the bolts evenly and gradually in the order shown.

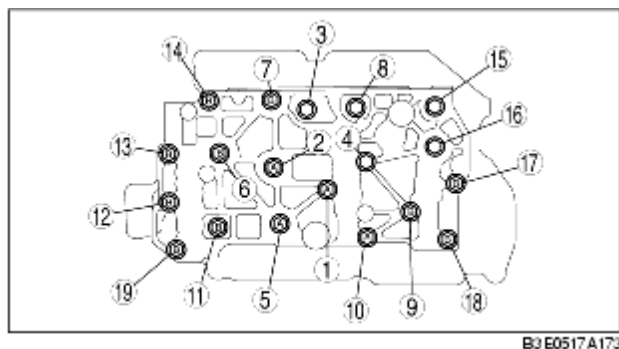

B3 E0517 A173

**Tightening torque****7.8-10.8 N·m****{80-110 kgf·cm, 69-95.5 in·lbf}**

10. Install the shift solenoid D, E, and pressure control solenoid.

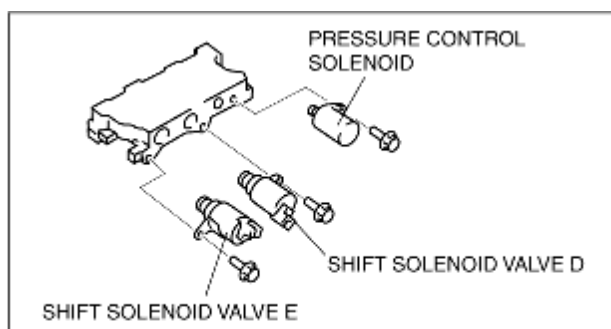

B3 E0517 A151

**Tightening torque****7.8-10.8 N·m****{80-110 kgf·cm, 69-95.5 in·lbf}**

11. Install the shift solenoid A, B, C.

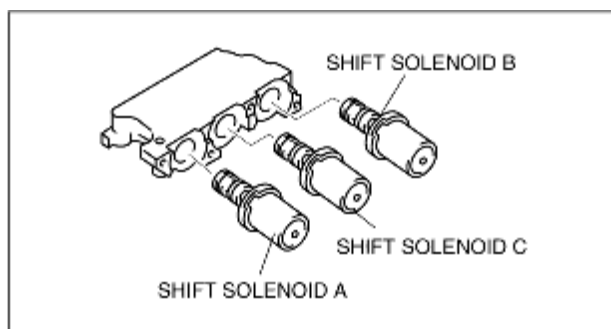

B3 E0517 A150

12. Install the bracket.

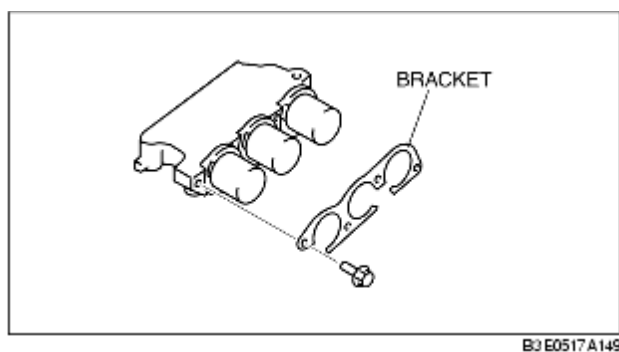

**Tightening torque**

**7.8-10.8 N·m**

**{80-110 kgf·cm, 69-95.5 in·lbf}**

13. Install the packing.

14. Apply ATF to new O-ring and install it onto the oil strainer.

15. Install the oil strainer onto the main control valve body.